

Axle Springs

BATEGU
Gummithechnologie GmbH & Co KG
1190 Vienna, Muthgasse 22
Austria

T. +43 (1) 368 21 53-0
F. + 43 (1) 368 21 53-24
office@bategu.at
www.bategu.at

Functional Description:

BATEGU axle springs are typically used as high-quality vibration-dampers in the bogies of railway vehicles.

By the vulcanization of each metal and elastomer layer, a consistent distribution of stress and strain over the entire cross-section is achieved. BATEGU axle springs are maintenance-free and cost saving due to their high durability. Different spring stiffness in three directions can be realised by the number of rubber layers and intermediate plates as well as the installation angle.

BATEGU axle springs are controlled 100% and come with a test report.

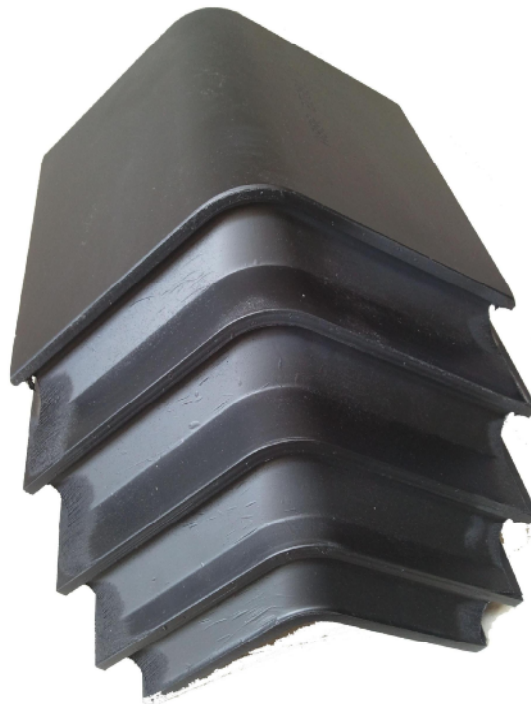

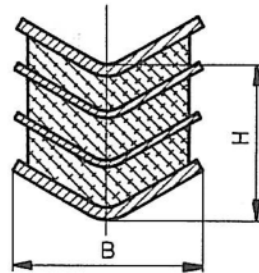
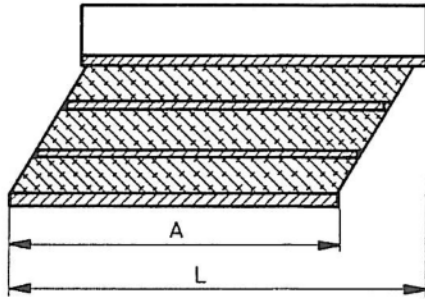

Artikel Nr.	L	B	H	A	Zeichnungs Nr.
VD 6007	263	120	93,5	200	3.030/7
VD 6303	307	145	93	246	70 08 10
VD 6007 b	235	120	93	200	93 11 07

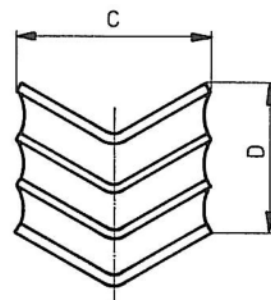
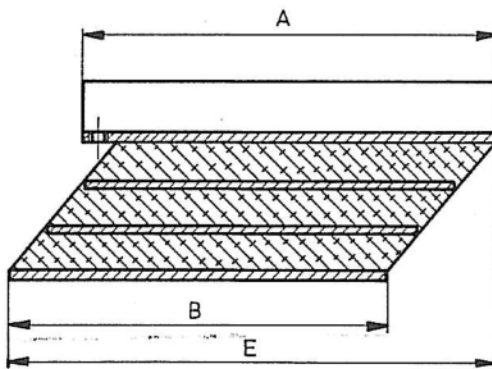

Artikel Nr.	A	B	C	D	E	Zeichnungs Nr.
VD 6462	260	240	125	93	313	74 12 03

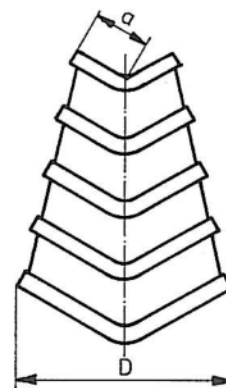
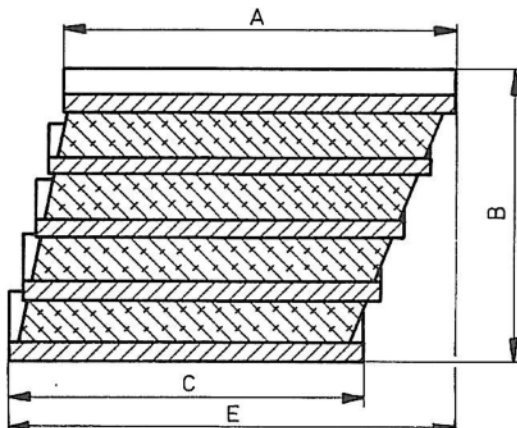

Artikel Nr.	A	B	C	D	a	E	Zeichnungs Nr.
VD 6572 b	236	155	180	200	85	280,5	G02 58 283 b
VD 7213	213	124	185	136	56	230	91 09 02
VD 7216	260	124	250	136	66	313	91 09 09

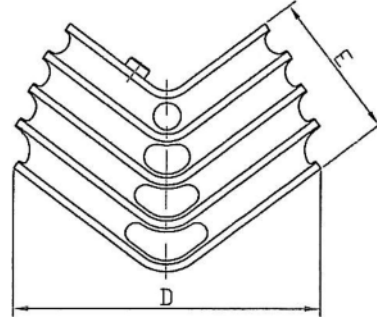
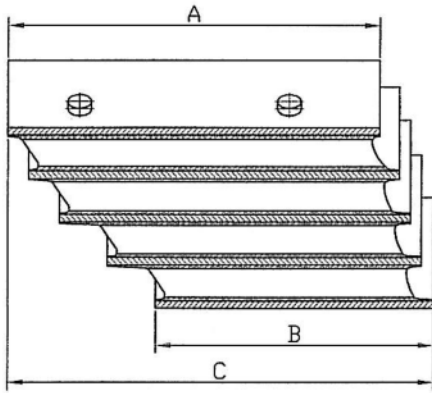

Art. Nr.	A	B	C	D	E	Zeichn. Nr.
K 857	300,75	225	344,75	248	121	96 02 04

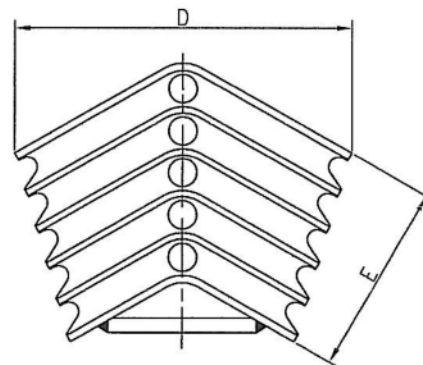
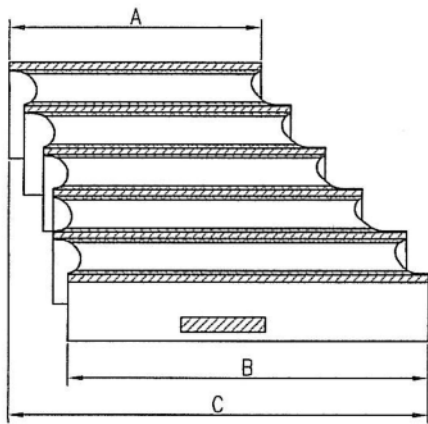

Art. Nr.	A	B	C	D	E	Zeichn. Nr.
VD 7408	203	292	341	272	155	97 12 04

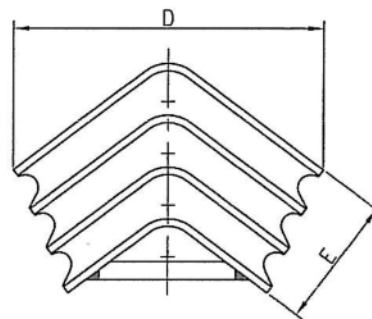
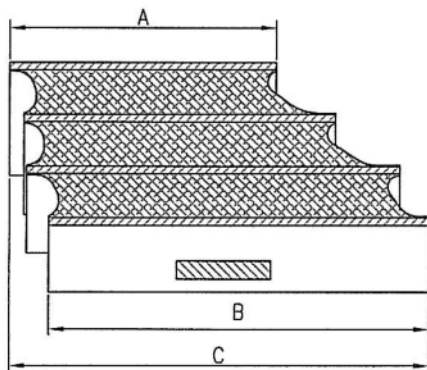

Art. Nr.	A	B	C	D	E	Zeichn. Nr.
VD 7409	216	308	340	251	106,35	97 11 06